

kubi Arm Replacement

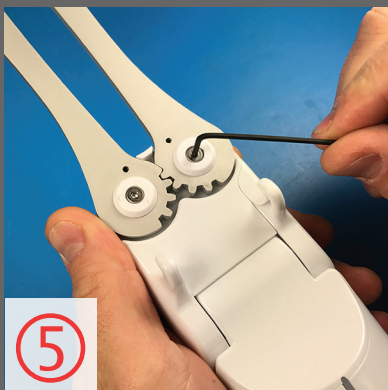
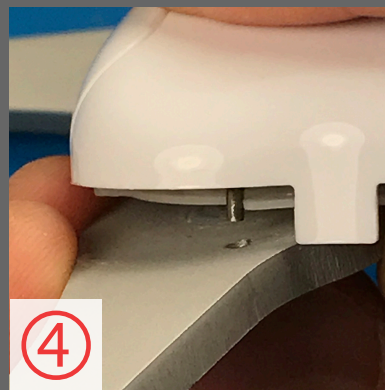
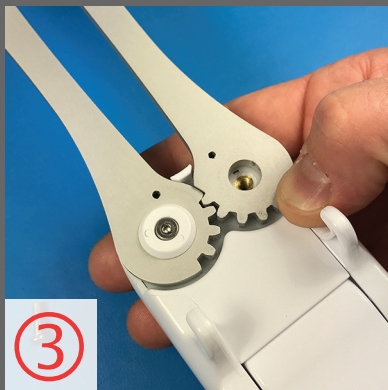
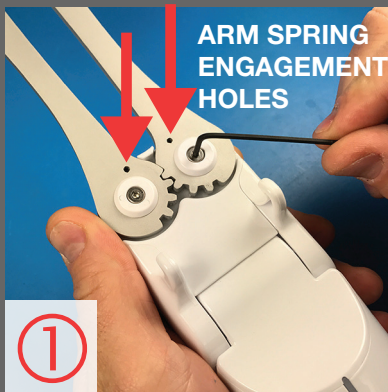

KUBI CLASSIC AND PLUS ARM REPLACEMENT INSTRUCTIONS

The goal of this procedure is to remove and replace each arm, one at a time. The arms engage springs that allow the arms to grip the tablet. IF THE ARM SPRINGS BECOME DISENGAGED, A SEPARATE OPERATION MUST BE PERFORMED!

① **Remove first arm:**
Use the supplied Allen wrench and remove the screw from the right bushing.

② ③ Keep downward pressure on the arm and carefully remove the bushing. Carefully lift and remove the right arm, taking care not to dislodge the spring shaft from its extended position.

④ ⑤ Align the replacement arm with gears toward centerline of the Kubi body and engage the gears of the other arm. Align the hole in the arm with the spring shaft and lower the arm, engaging the spring in the arm hole. Re-install the bushing and screw. IF THE ARM SPRING DISENGAGES WHEN INSTALLING ARM, SEE PAGE 2.

⑥ Repeat steps 1 through 5 to replace second arm. Arms should open and close smoothly. Loosen screws slightly if arm return motion is restricted.

kubi Spring Engagement

ARM RETURN SPRING REENGAGEMENT PROCEDURE

IF YOU ALLOWED AN ARM OR BOTH ARMS TO DISENGAGE THE ARM RETURN SPRINGS WHILE THE SCREWS WERE NOT INSTALLED. FOLLOW THIS PROCEDURE TO RE-ENGAGE THE SPRINGS IN THE ARMS.

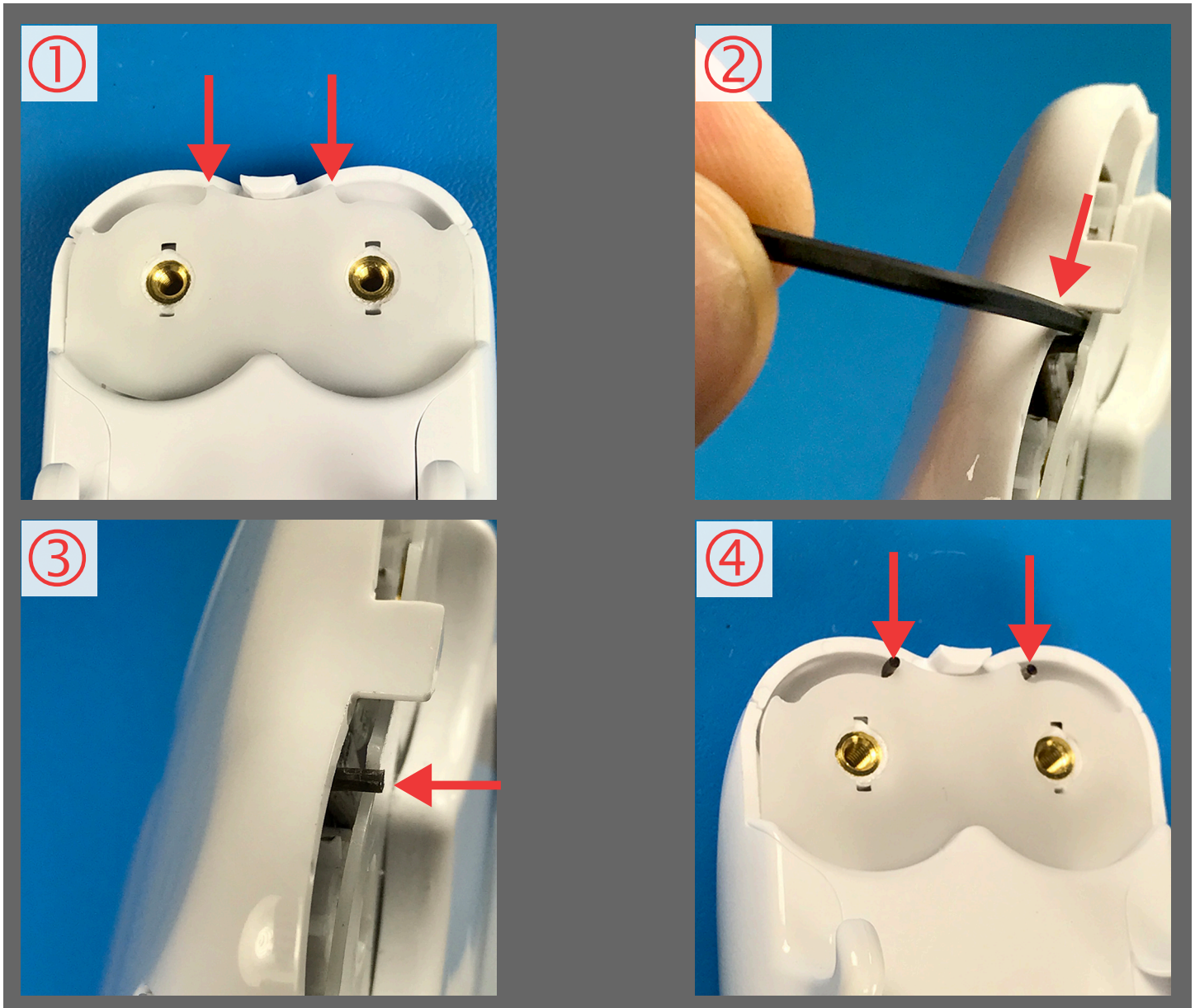

- ① Image of kubi with arms removed: springs have slipped off of the spacer notches (red arrows) and are retracted behind white spacer .
- ② To engage springs in notches, use the supplied Allen wrench as a lever to pry the spring end onto the notch in the white spacer.
- ③ Spring is engaged in notch. Repeat step 2 on second spring before installing arms.
- ④ Image of both springs engaged in notches (red arrows), ready for arm installation.